



WELCOME

Building Task Force Congregational Input Meeting

January 26, 2020

Unitarian Universalist Church of Columbia



Agenda

- Chalice Lighting
- Summary of Next Steps Weekend
- Building Plans from Simon Oswald Architecture
- Input from Members
- Where to From Here
- Closing



Chalice Lighting

We light this chalice with the hope that we bring
our mission to life with each new day.

In the spirit of courageous love
we forge a community of radical welcome and
deep connection that moves us together
to heal the world.



Next Steps Weekend

Rachel Maxwell

UU Stewardship Consultant

Purpose

- Independent professional assessment of capacity and readiness for capital campaign
- Recommend next steps



Next Steps Weekend

Rachel Maxwell

UU Stewardship Consultant

Before and during visit Rachel:

- Reviewed documents;
- Met with 35 staff, leaders, members/friends;
- Provided presentation and report.



Next Steps Weekend

Rachel Maxwell

UU Stewardship Consultant

Blessings:

- Inspiring minister
 - Deeply connected to mission and vision
 - Programming strong and varied
 - Appear to be growing in both impact and numbers
 - Leadership is creative and committed
 - Nurture diverse spiritual need
 - Campus is large with beautiful natural wooded area
 - Love and accept differences
-



Next Steps Weekend

Rachel Maxwell

UU Stewardship Consultant

Challenges:

- Facility not fully accessible
 - Small parking lot
 - Sunday mornings crowded inside and outside of sanctuary
 - Desire to reduce fossil fuel dependence and be green
 - Inadequate meeting spaces
 - Limited calm, quiet sacred space indoors
-



UUCC Attendance Data

- 1) Experts tell us that once the seats in the sanctuary are >80% full, the space will “feel” full and visitors will not feel welcomed;
- 2) Currently our sanctuary has a 120-140 seating capacity;
- 3) The data below reflect the adults in attendance at both (9 & 11 am) services, but not the children;
- 4) For most Sundays the # of children at the start of the 11 am service exceeds the # of adults at the 9 am service.

Sunday Service Attendance (Aug. 2015 - Sept. 2019)

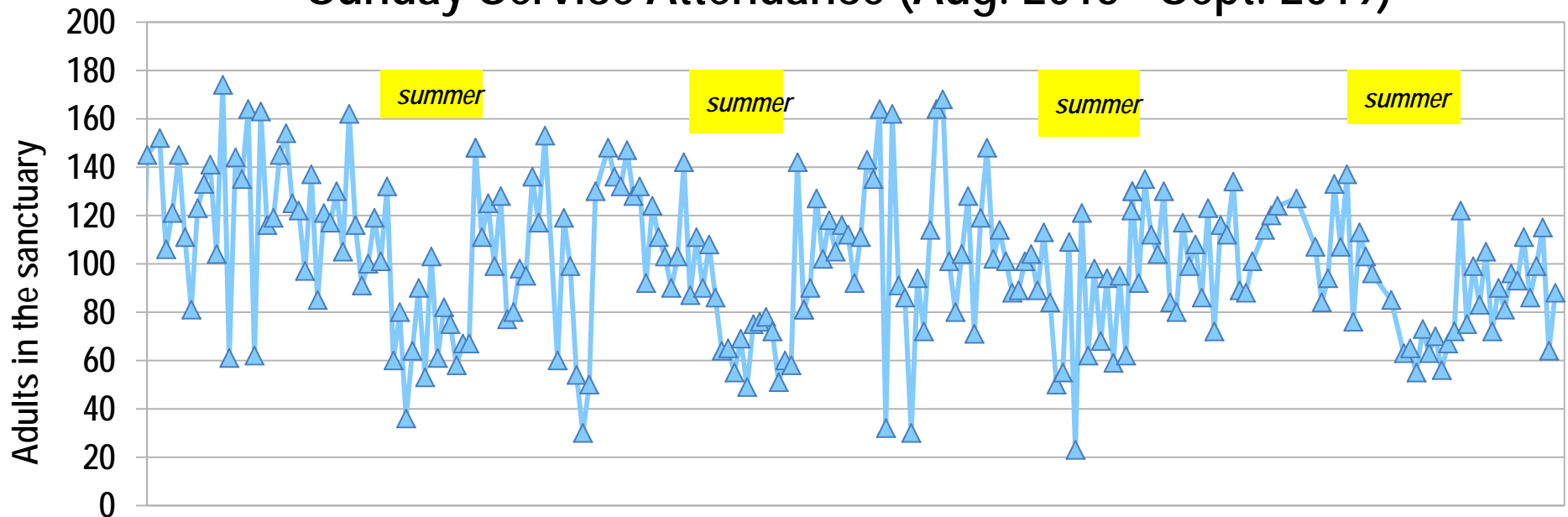

Despite growth in membership Sunday service attendance has peaked.

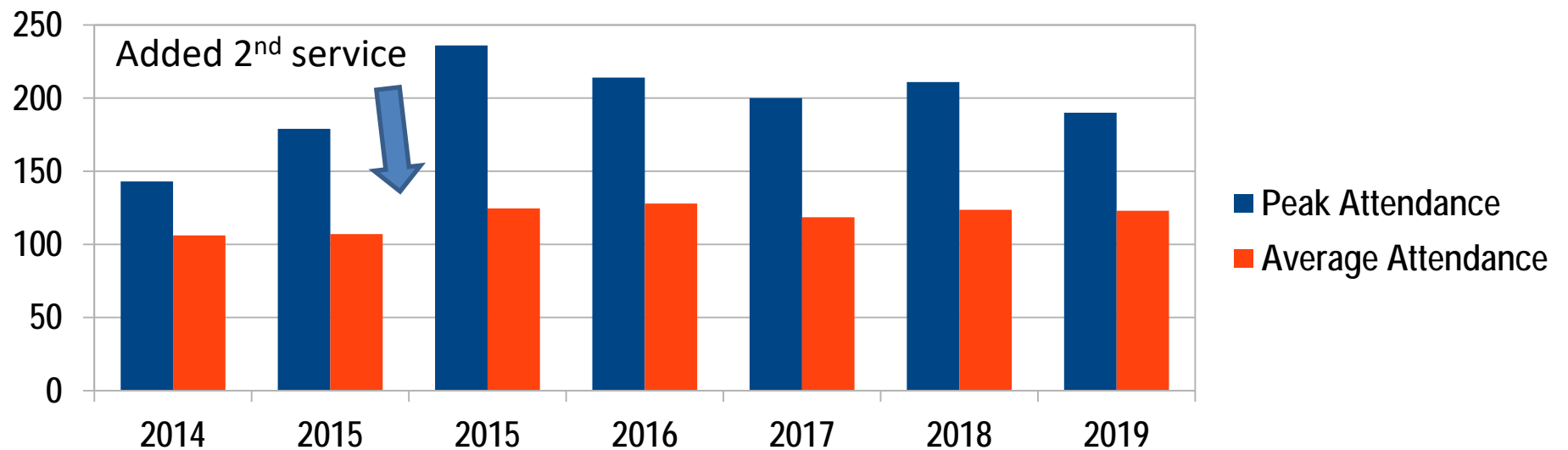
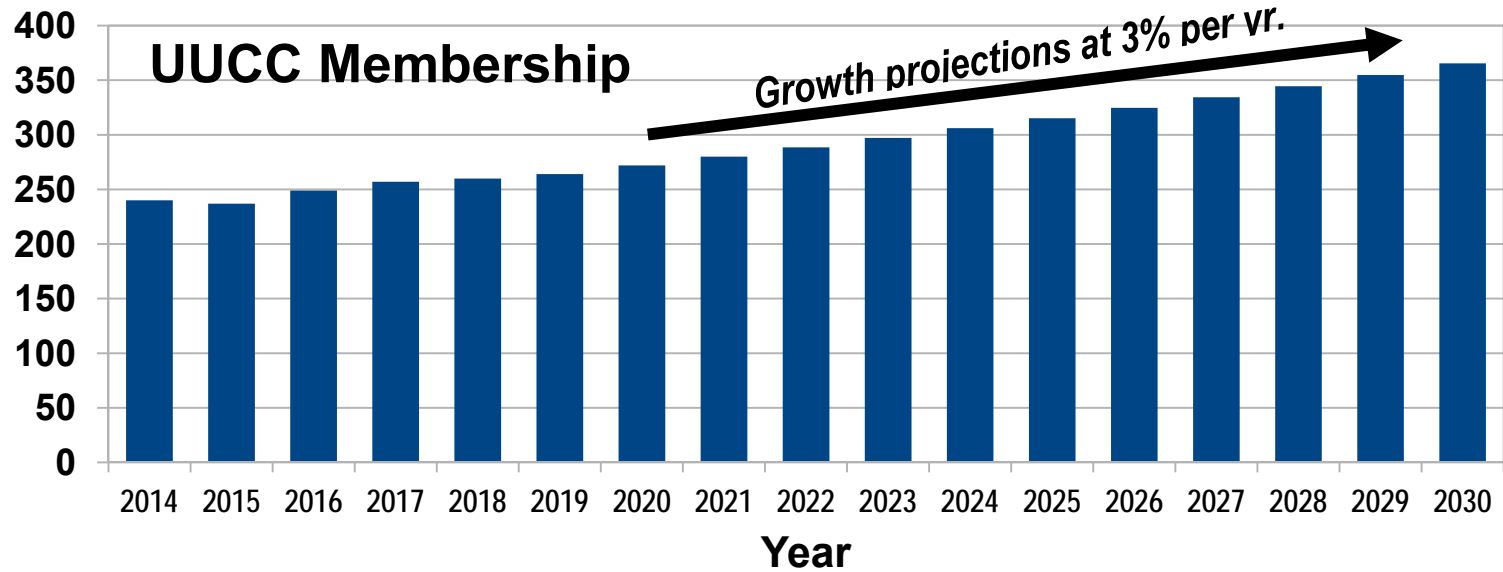

Next Steps Weekend

Rachel Maxwell

UU Stewardship Consultant

Conclusion:

The UUCC congregation is healthy and well poised to expand its impact in the wider community.

The facility needs to reflect the congregation's missional radical welcome and make it manifest in UUCC's built environment.



Next Steps Weekend

Rachel Maxwell

UU Stewardship Consultant

Recommendations for Next Steps

1. Gather robust data on congregational growth and giving
2. Revisit what you need for your facility in light of new data and other information
3. Reduce anxiety about talking about money
4. Create a Strategic Financial Forecast
5. Recruit a Capital Campaign Team and begin your journey toward a facility that more clearly reflects your mission and your values



Today's Congregational Input

- #2 Recommendation: *Revisit what we need for the facility in light of new data and other information;*
- If we were more fully living our mission of radical welcome and deep connection what would we look like?



Master Plans

Simon Oswald Architecture

- First draft two phases;
 - Engage them for one phase revision;
 - Gathering input today.
-





6 - Two meeting rooms
(carved out of existing space)

5 - Remodeled sanctuary
(150-160 seating capacity)

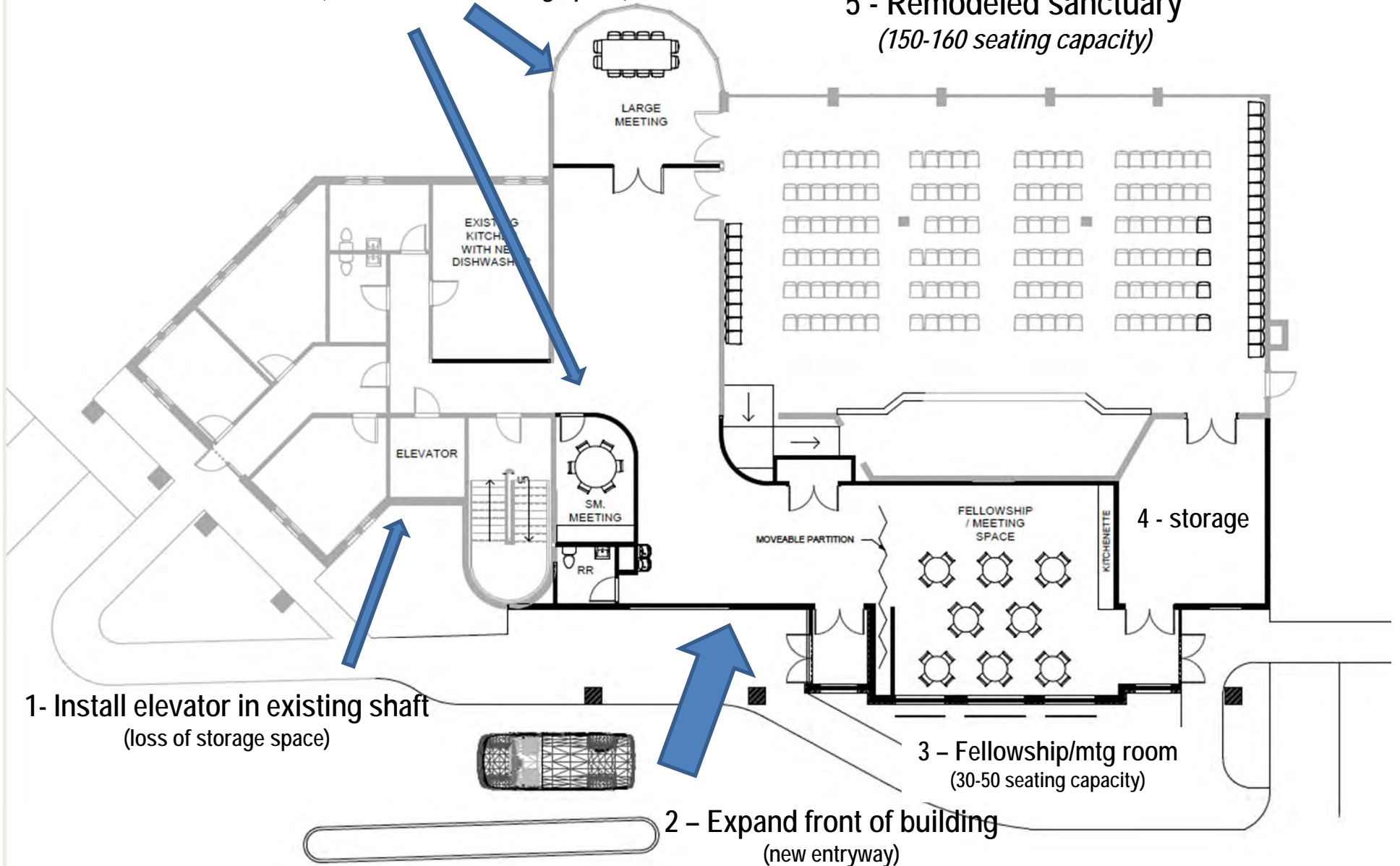

1 - Install elevator in existing shaft
(loss of storage space)

2 - Expand front of building
(new entryway)

3 - Fellowship/mtg room
(30-50 seating capacity)

Phase 2
(~10-20 yrs later)

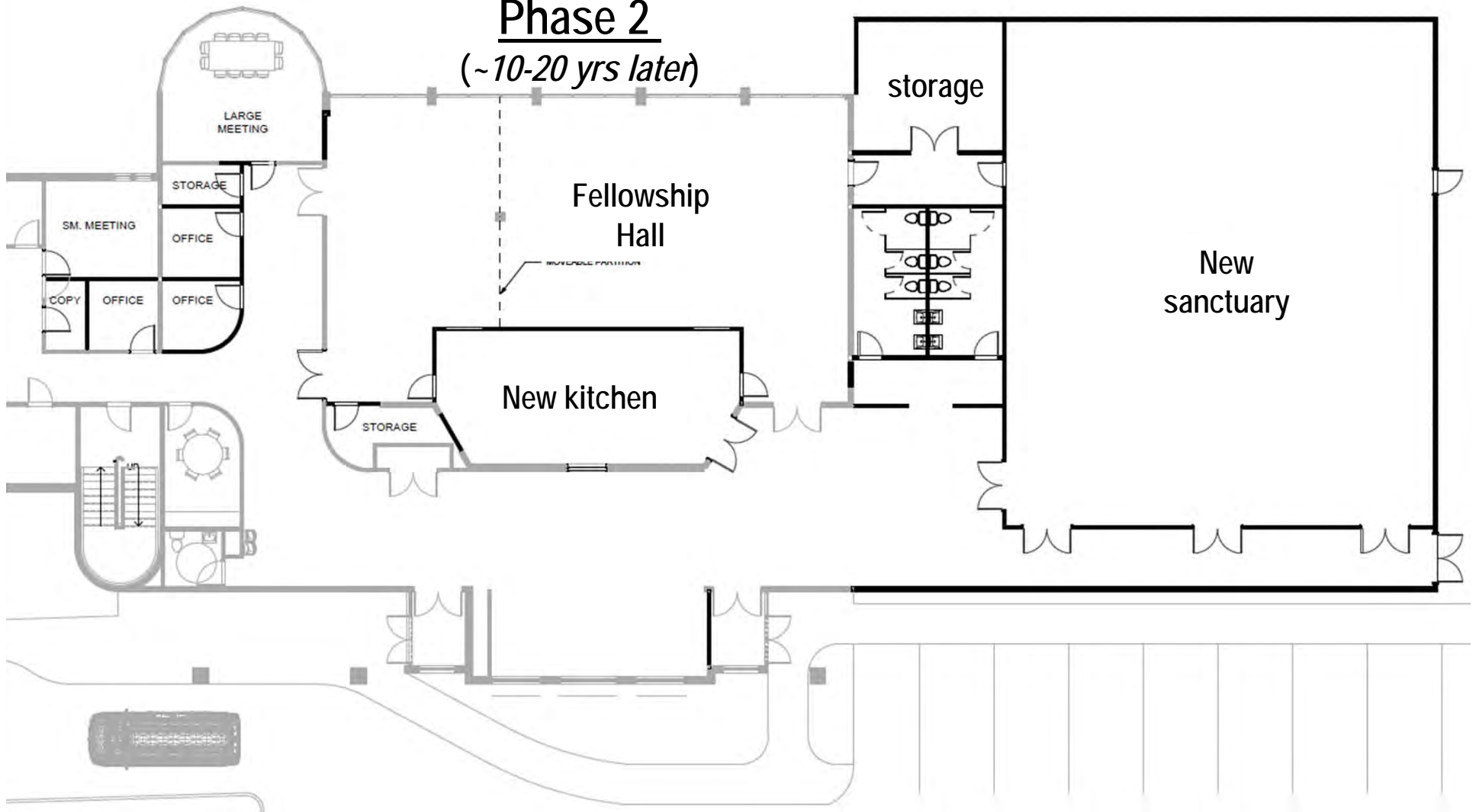

Congregational Input

- Form groups of 3 for sharing;
 - Introductions (two sentences or less):
 - Name
 - How long you have been coming to UUCC
 - What do you like best about UUCC
-



Congregational Input *(continued)*

Write on note card three to five things you'd most like see if we were more fully living our mission of radical welcome and deep connection.



Congregational Input *(continued)*

In small group share ideas with each other:

- 2 minutes for each person;
 - LISTEN to each other;
 - Do not discuss merits;
 - Only ask clarifying questions.
-



Congregational Input *(continued)*

- Each group choose one reporter;
- Report to large group;
- Top things from your group.



Congregational Input *(continued)*

- Anything you're passionate about not on list?
-



Possible Timeline

Winter/Spring 2020

- Data check about growth and numbers;
 - Work with SOA on revisions and costs;
 - Annual Stewardship Drive as usual;
 - Develop Financial Forecast;
 - Host more ways for input on plans being developed.
-



Possible Timeline

Summer 2020

- Rev. Molly sabbatical;
- Continue work on Capital Campaign and Building plans;
- Money story sessions...



Possible Timeline

Fall 2020

- Rev. Molly returns;
- Building plans gelled;
- Educate congregation about building plans and campaign process;
- U.S. Presidential election ... VOTE!!!!
- Conduct Feasibility Study and report results.



Possible Timeline

Winter/Spring 2021

- Hone Capital Campaign goal and finalize strategy;
 - Congregational vote on Capital Campaign;
 - Visiting Steward training;
 - Quiet/leadership phase of campaign;
 - Launch Capital Campaign w/ Annual Stewardship Drive held at same time;
 - Conduct stewardship visits.
-



Possible Timeline

Summer 2021

- Break ground!!??
- Elevate our mission!



Any

Questions?

Closing

Extinguish the chalice:

*“Alone we can do so little;
Together we can do so much.”*

- Helen Keller

